

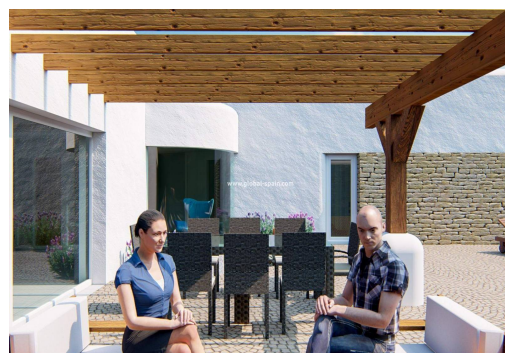

REF. PS-26410
New Build · Villa · Alfas del Pi

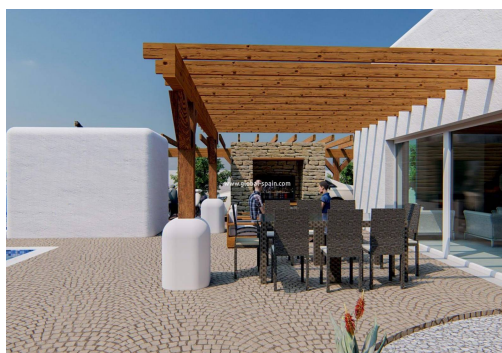

4 BEDROOMS

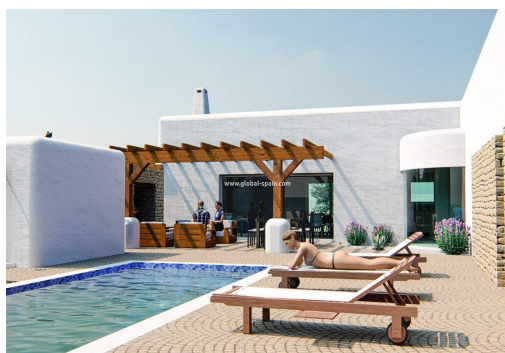

2 BATHROOMS



169M²



820M²



PRIVATE



B

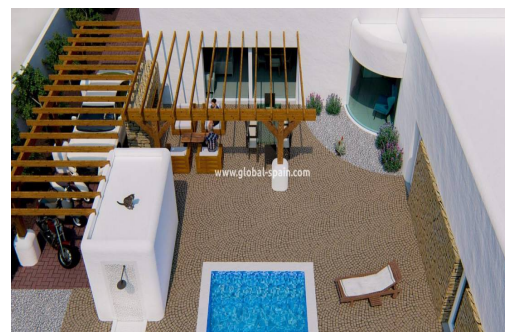
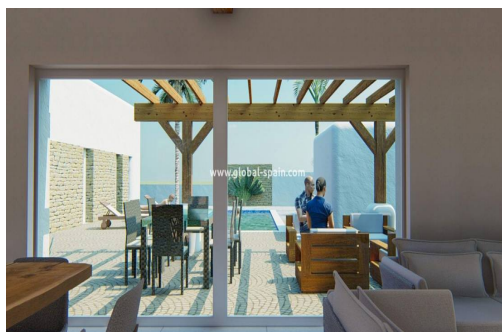

NEW BUILD IBIZA STYLE VILLAS IN ALFAZ DEL PI Fantastic New Build Ibiza style villas in Alfaz del Pi, close to the El Arabi urbanization. Connected to the urban centre of Alfaz del Pi (shops, sports centre, schools) and a few minutes from El Albir with easy connection. This is a one storey house that is articulated in "L" shape, having a public volume (kitchen, living room and dining room) and a public volume (3 bedroom, 2 bathroom, 1 office space, 1 laundry/utility room). That are connected by a rounded hall with a curved glass that receives the user when arriving to the house, by the look of an olive tree and the big terrace/pool area oriented towards the south. The private area has a roof height above normal, decorated with wooden beams, wooden wall and kitchen panels. There is a massive large sliding window that is embedded on the wall when closed, connecting to a large pergola area that works as a buffer space in between the interior spa...

key features

- Bedrooms: 4
- Built: 169m²
- Energy Rating: B
- Bathrooms: 2
- Plot: 820m²

Characteristics

- Air Conditioning: Pre-Installed
- Double Bedrooms: 4
- Gated
- Near Commercial Center
- Number of Parking Spaces: 1
- Terrace: 52 Msq.
- Beach: 3500 Meters
- garden
- Location: Coastal
- Near Schools
- Private Pool
- Useable Build Space: 135 Msq.